

E0-16845-0

REVISIONS

2

CONVERTED TO MICROSTATION, REVISED NOTES LRD(SEA) 01/20/06

3

UPDATED NOTE 2 WITH NEW PSIG AND TEMP. RATINGS RSH 08/27/08

4

DELETED 2" SIZE CHANGED TITLE DK/KY 02/14/11

19 TUBES WALL THICKNESS TO BE SPECIFIED BY VENDOR.

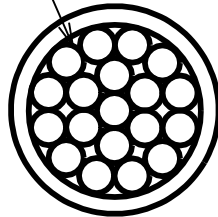

FLANGE TO BE WELDED TO TUBES AT ALL POINTS OF CONTACT

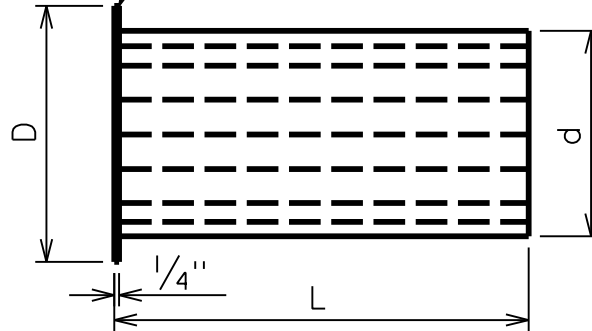

DIMENSION "d" TO FIT I.D. OF PIPE SPECIFIED IN TABLE

ALL DIMENSION IN INCHES

TABLE			
SIZE	d NOMINAL I.D. OF PIPE	L LENGTH	D FLANGE DIAMETER
3	3.068	9	5
4	4.026	10	6 ³ / ₁₆
6	6.065	12	8 ¹ / ₂
8	7.981	16	10 ⁵ / ₈
10	10.020	20	12 ³ / ₄
12	12.000	24	15
16	15.250	32	18 ¹ / ₂

NOTES:

1. MATERIALS:
PLATE-ASTM A-240, TYPE 304 SEAMLESS
PIPE OR TUBE-ASTM A-312, TYPE 304
2. USE FOR STEAM AT 400 PSIG AND 475°F.
3. DESIGNED, CONSTRUCTED, MANUFACTURED AND TESTED TO ASME STANDARD MFC-3M-2004 UNLESS OTHERWISE NOTED.
4. FLANGE RING TO BE CONSTRUCTED SO THAT IT CAN BE CLAMPED BETWEEN TWO PIPE LINE FLANGES.
5. EACH TUBE TO BE WELDED TOGETHER AT THE POINTS OF CONTACT, AT LEAST AT BOTH ENDS OF THE TUBE BUNDLE.
6. THE FLOW STRAIGHTENER TO BE MOUNTED BETWEEN CLASS 300 FLANGES, ANSIB16.5.

APPROVED MANUFACTURERS:

DANIEL ORIFICE FITTING CO.
PERRY EQUIPMENT ORIFICE FITTING CO.
FLUIDIC TECH INC.

TUBE BUNDLE FLOW STRAIGHTENERS
FOR USE WITH
STEAM FLOW METER

CONSOLIDATED EDISON COMPANY OF N.Y., INC.
STEAM DISTRIBUTION ENGINEERING

DATE 08-12-88

DWG.

REV.

LAST REV. 02-14-11

NO.

S-464

4